

Quick Start Guide

SpeedFace - V5L[TD]

Version: 1.0

Overview

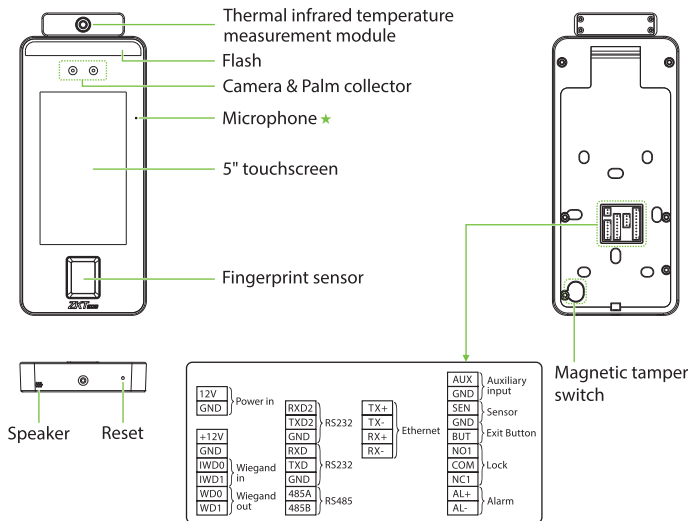

Note: Not all products have the function with ★, the real product shall prevail.

Installation Environment

Please refer to the following recommendations for installation.



INDOOR USE



AVOID GLASS REFRACTION



AVOID DIRECT SUNLIGHT AND EXPOSURE



FAR AWAY HEAT SOURCE

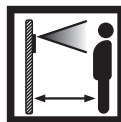

KEEP EFFECTIVE DISTANCE 0.3-2m

Device Installation

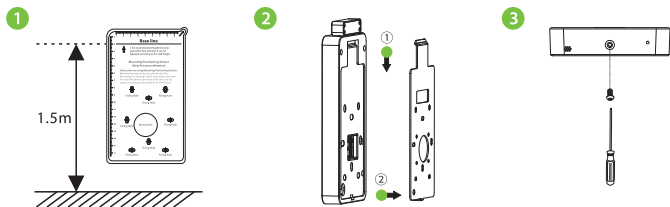

- ① Attach the mounting template sticker to the wall, and drill holes according to the mounting paper. Fix the back plate on the wall using wall mounting screws.
- ② Attach the device to the back plate.
- ③ Fasten the device to the back plate with a security screw.

Standalone Installation

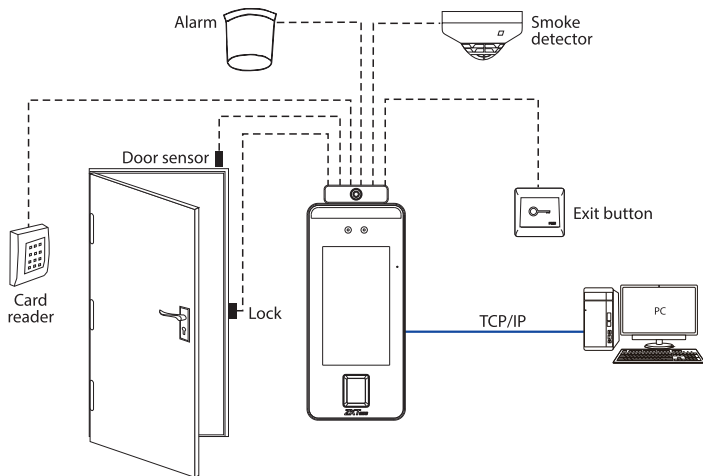

Door Sensor, Exit Button & Alarm Connection

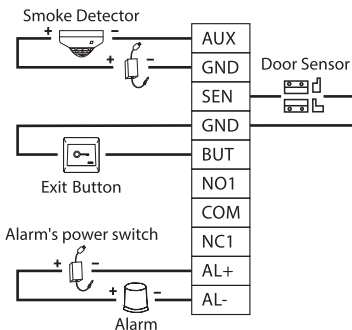
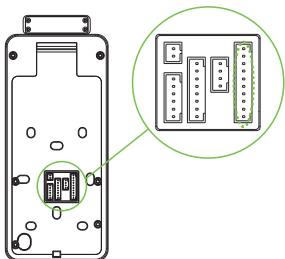

Lock Relay Connection

The system supports Normally Opened Lock and Normally Closed Lock.

The NO LOCK (normally opened at power on) is connected with 'NO1' and 'COM' terminals, and the NC LOCK (normally closed at power on) is connected with 'NC1' and 'COM' terminals. Take NC Lock as an example below:

1) Device not sharing power with the lock

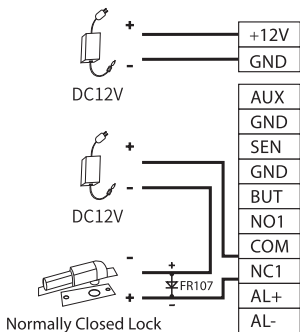

2) Device sharing power with the lock

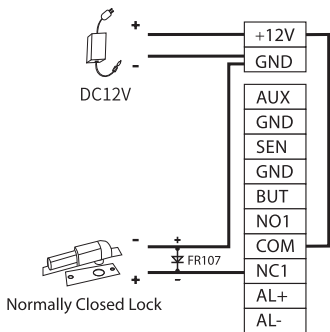

RS485 and RS232 Connection

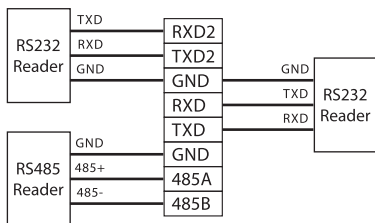
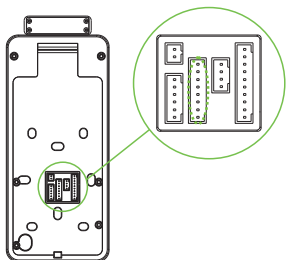

Wiegand Reader Connection

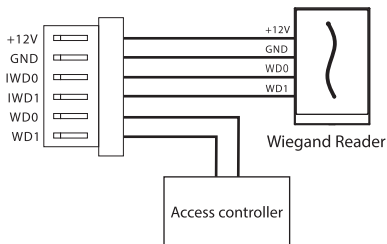
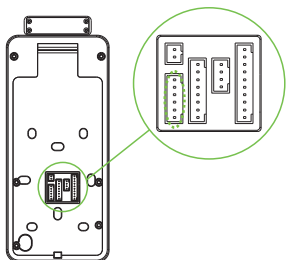

Power Connection

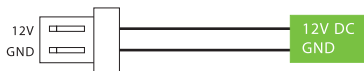
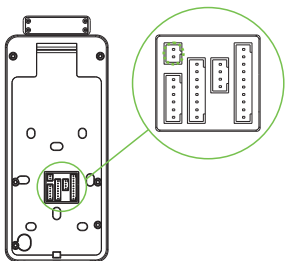

Recommended power supply

- 1) 12V \pm 10%, at least 3000mA.
- 2) To share the power with other devices, use a power supply with higher current ratings.

Ethernet Connection

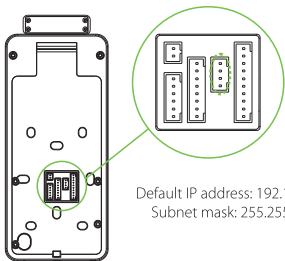

Default IP address: 192.168.1.201
Subnet mask: 255.255.255.0

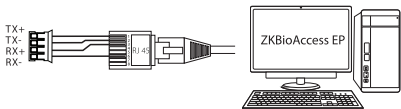

IP address: 192.168.1.130
Subnet mask: 255.255.255.0

Click [COMM.] > [Ethernet] > [IP Address], input the IP address and click [OK].

Note: In LAN, IP addresses of the server (PC) and the device must be in the same network segment when connecting to ZKBioAccess EP software.

User Registration

When there is no super administrator set in the device, click on ☰ to enter the menu. After setting the super administrator, the system will request for the administrator's verification before entering the menu. For the security purpose, it is recommended to register a super administrator at the first time you use the device.

Method 1: Register on the device

Click on ☰ > [User Mgt.] > [New User] to register a new user. Settings include entering user ID and name, registering a palm, fingerprint, face, password, badge (optional) and user photo, setting user role.

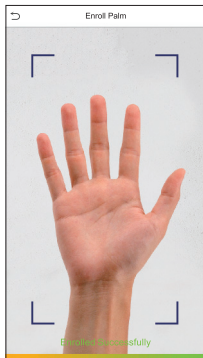
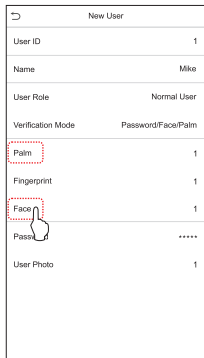
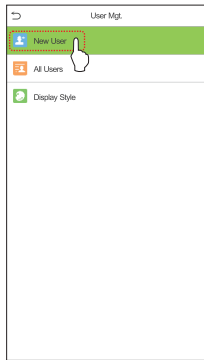
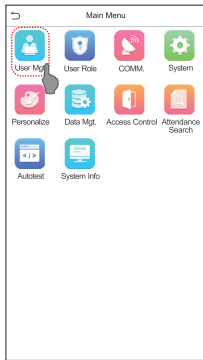
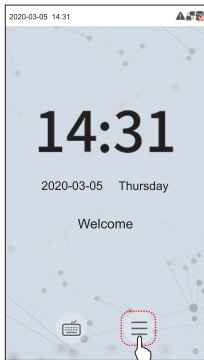

Method 2: Register on ZKBioAccess EP software

Please set the IP address and cloud service server address on the device.

1. Click [Access] > [Access Device] > [Device] > [Search Device] to add the device to the software.

When the device has set the server address and port, it can be added automatically.

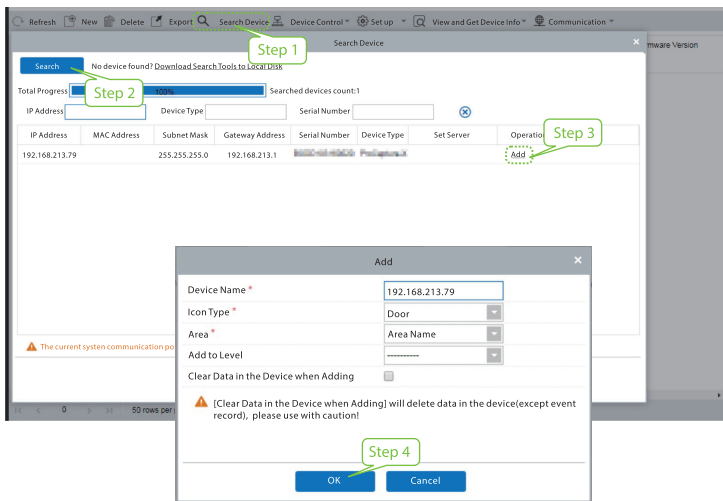

2. Click [Personnel] > [Person] > [New] to register users in the software.

3. Add users to access levels.

4. Click [Access] > [Device] > [Device Control] > [Synchronize All Data to Devices].

For more details, please refer to the ZKBioAccess EP User Manual.

Method 3: Register on the phone

Once ZKBioAccess EP software installed, users could enroll face via browser application on their own mobile phone.

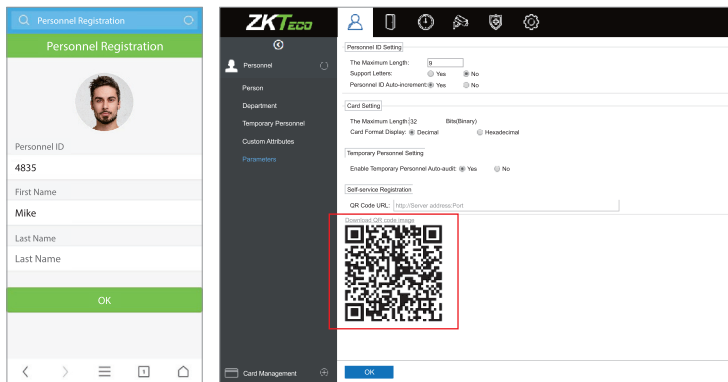

1. Click **[Personnel]** > **[Parameters]**, input “http://Server address:Port” in the QR Code UGL bar. The software will automatically generates a QR code. Scan the QR code or login onto “http://Server address:Port/app/v1/adreg” by the mobile phone to register users.



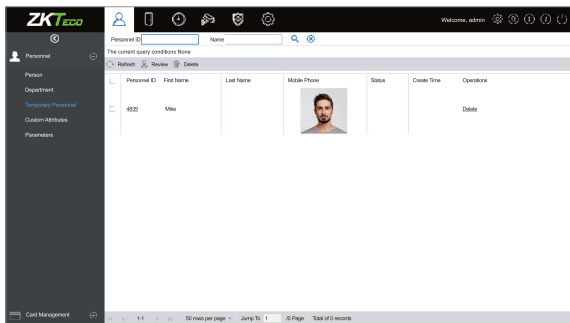

2. The users will display in **[Personnel]** > **[Temporary Personnel]**, click **[Review]**.



Ethernet and Cloud Server Settings

Click on  > [COMM.] > [Ethernet] to set the network parameters. If the TCP/IP communication of the device is successful, the icon  will be displayed in the upper right corner of the standby interface.

Click on  > [COMM.] > [Cloud Server Setting] to set the server address and server port, that is, the IP address and port number of the server after the software is installed. If the device communicates with the server successfully, the icon  will be displayed in the upper right corner of the standby interface.

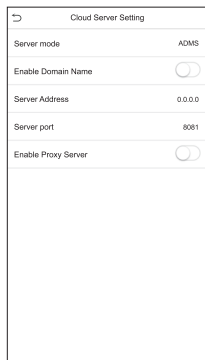
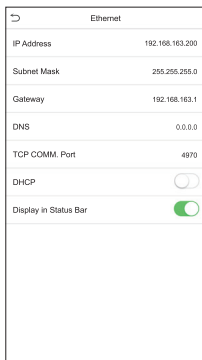
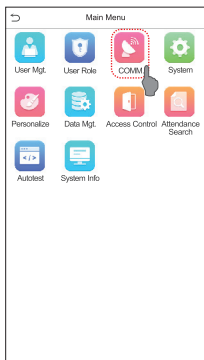

Access Control Settings

Click on  > [Access Control] to enter the access control management interface and set relevant parameters of access control.

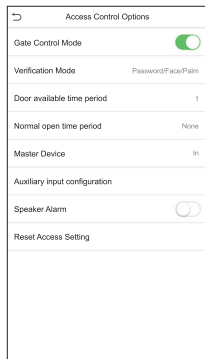
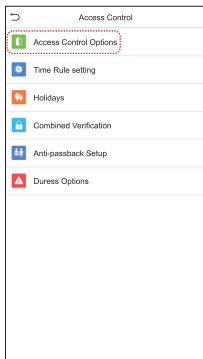
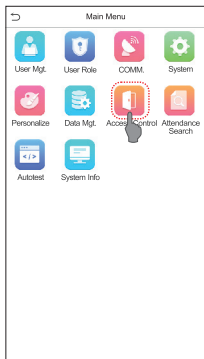

Records Query

Click on > [Attendance Search] > [Attendance Record] to enter the records query interface, input the user ID and select the time range, the corresponding attendance logs will be displayed.

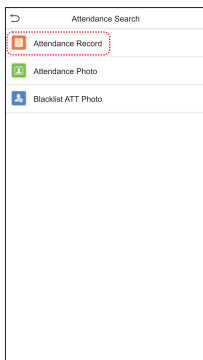
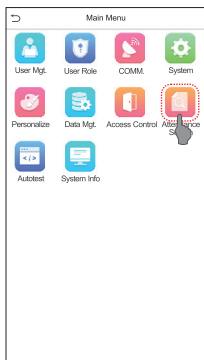

Personal Record Search

Date	User ID	Access records
03-03		Number of Records:04
	4	11:25
	2	11:25 11:22
	3	11:25
03-04		Number of Records:04
	1	11:29
	3	11:29 11:21
	2	11:28
	4	11:26
03-05		Number of Records:04
	1	11:27
	4	11:27
	3	11:27
	2	11:27

Detection Management Settings

Click on  > [System] > [Detection Management] to enter the detection management interface. You can set the value of **High temperature alarm threshold**. The device will send an alarm prompt when the temperature of the user detected exceeds this value. When the **Temperature over the range; access denied** is enabled, the user will be forbidden to access, as shown in the following figure.

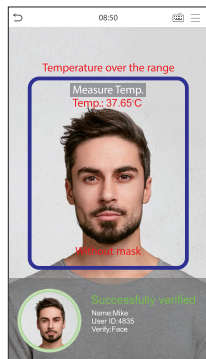
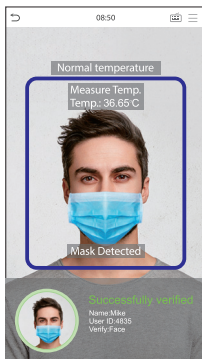
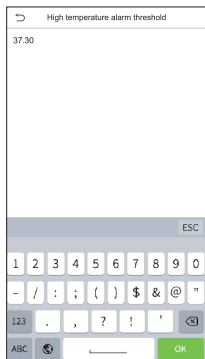
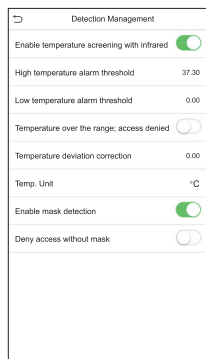
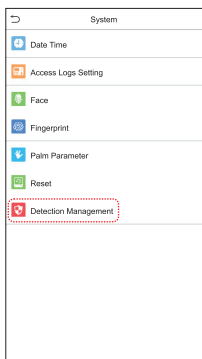
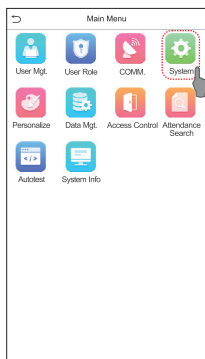

Notes:

1. The effective distance for temperature detection is within 50cm.
2. Recommended for indoor use.
3. Temperature measurement data is for reference only, not for medical use.
4. Remove the mask to register the face, wear a mask to recognize the face, the type of mask, the size of the face covered by the mask, and bangs will affect the facial recognition effect.
5. Facial verification for masked individuals will increase FAR. Palm verification for masked individuals is recommended.

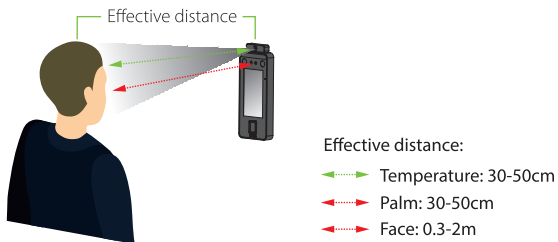

Real-time monitoring on the ZKBioAccess EP software

Once ZKBioAccess EP software installed, users could perform epidemic management on browser.

Please set the IP address and cloud service server address on the device and add the device to the software.

1. Click **[Prevention]** > **[Epidemic]** > **[Real-time monitoring]** to view all the events include the user whose temperature is over the range.

When the **Alarm temperature setting** has set, the abnormal body temperature will be marked red automatically.

2. Click **[Epidemic]** > **[Statistics panel]** to view the analysis of statistical data and view the personnels with normal temperature.

As shown in the following figure.

ZKTeco Welcome, admin

Temperature management

Alarm temperature setting

Time	Area	Device	Event Point	Personnel ID	First Name	Department	Body temperature	Mask	Status
2020-04-01 14:20:53	Area Name	192.168.1.120	192.168.1.120-1	2			36.0		Normal
2020-04-01 14:20:43	Area Name	192.168.1.120	192.168.1.120-1	2			36.0		Normal
2020-04-01 10:50:21	Area Name	192.168.1.120	192.168.1.120-1	2	Jack	Sales	36.0	None	Exception

Total Received: 2 Normal: 2 Exception: 1 Alarm: 0 Clear Data Boxes

Alarm alert



Number: 1
 First Name: Jack
 Department: Sales
 Body temperature: 37.7
 Area: Area Name
 Device: 192.168.1.120
 Time: 2020-04-01 10:50:21

Close

ZKTeco Welcome, admin

Epidemic management

Statistics

Time: This week

The current query conditions: None

Refresh

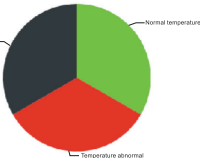

Normal temperature Temperature abnormal Unmeasured body temperature

View Normal temperature People

Personnel ID: Department Name:

The current query conditions: None

Refresh

Personnel ID	First Name	Department Number	Department Name
3		1	Sales
2		1	Sales

1-2 50 rows per page Jump To: 1 / 1 Page Total of 2 records

For more details, please refer to the ZKBioAccess EP User Manual.

Note for Palm Registration and Verification

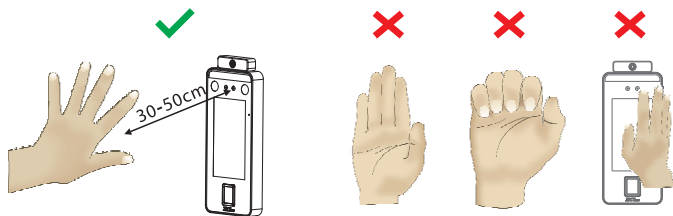

Notes:

1. Place your palm within **30-50cm** of the device.
2. Place your palm in the palm collection area, such that the palm is placed parallel to the device.
3. Make sure to keep space between your fingers.

ZKTeco Industrial Park, No. 26, 188 Industrial Road,
Tangxia Town, Dongguan, China.

Phone : +86 769 - 82109991

Fax : +86 755 - 89602394

www.zkteco.com

